

GUTEX® Thermowall/-gf Data Sheet



Fotos: GUTEX Archiv, HUF-Haus

GUTEX Thermowall a single ply plaster baseboard with homogenous cross section, is the ideal choice for environmentally friendly use with GUTEX's composite thermal insulation systems.

Technical data	Thermowall				Thermowall-gf	
	stumpf			Tongue & groove	Tongue & groove	Butted
Joint						
Length (mm)	1250	830	2600/2800	1300	1300	2600/2800
Width (mm)	590	600	1250	600	600	1250
Thickness (mm)	20/40/60/80	100/120/140/160	80/100/120	80/100/120	40/60	40/60
Actual coverage (LxW) (mm)				1276x576	1276x576	
Square metres per board (m ²)	0,738	0,498	3,25/3,5	0,78	0,78	3,25/3,5
Weight per board (kg)	2,4/4,7/7,1/9,5	8,0/9,6/11,2/12,8	41,6/44,8/52/56 62,4/67,2	9,9/12,5/15,0	5,9/8,9	24,7/16,6/ 37,1/40,0
Weight per m ² (kg)	3,2/6,4/9,6/12,8	16/19,2/22,4/25,6	12,8/16/19,2	12,8/16/19,2	7,6/11,4	7,6/11,4
Boards per pallet	220/108/72/54	40/32/28/24	13/10	54/44/36	108/72	25/17
Square metres per pallet (m ²)	162,25/79,65/ 53,1/39,83	19,92/15,94/ 13,94/ 11,95	42,25/45,5/ 32,5 /35/ 26/28	42,12/34,32/ 28,08	84,24/56,16	81,5/87,5 52/56
Weight per pallet (kg)	540	320	560/600/600	590/540/550	680	640/680
Bulk density (kg/m ³)	160	160	160	160	190	190
Thermal conductivity λ_D (W/mK)	0,039	0,039	0,039	0,039	0,043	0,043
Thermal resistance R _D (W/mK)	0,55/1,05/ 1,55/2,05	2,6/3,1/ 3,6/4,1	2,05/2,6/3,1	2,05/2,6/3,1	0,95/1,4	0,95/1,4
Vapour diffusion factor (μ)	3	3	3	3	3	3
sd-value (m)	0,06/0,12/ 0,18/0,24	0,3/0,36/ 0,42/0,48	0,24/0,30/0,36	0,24/0,30/0,36	0,12/0,18	0,12/0,18
Compression resistance/Comp. strength (kPa)	≥ 100	≥ 100	≥ 100	≥ 100	≥ 200	≥ 200
Air flow resistivity (kPa s/m ³)	≥ 100	≥ 100	≥ 100	≥ 100	≥ 100	≥ 100
Specific heat capacity (J/kgK)	2100	2100	2100	2100	2100	2100



Designation Thermowall: WF-EN13171-T4-WS1,0-CS(10/Y)100-TR10-MU3-AF100.
Designation Thermowall-gf: WF-EN13171-T4-WS1,0-CS(10/Y)100-TR30-MU3-AF100.

Material:

- Manufactured from untreated Black Forest spruce and fir
- Binding agent: 4% polyurethane resin
- Hydrophobizing agent: 1.5% paraffin

Applications

- Plaster baseboard for GUTEX Thermowall composite thermal insulation systems over non-vented wood and solid wood substrate constructions.
- GUTEX Thermowall/-gf installs on the insides of walls to provide insulation. It also serves as plaster baseboard.

Advantages:

- Superior thermal storage capacity provides outstanding insulation against heat in the summer and cold in the winter
- Improved soundproofing
- Vapour permeable
- Manufactured in Germany (Black Forest)
- Manufactured from wood, a sustainable, recyclable natural resource
- Biologically safe (natureplus certified)

Application Examples:

Installation Over Solid Wood or Masonry Substrates:

Board	Length x Width (cm)	Thickness (mm)	Joint	λ W/mK
GUTEX Thermowall	60 x 130	80 / 100/120	T&G	0,042
	125 x 260/280	80 / 100/120	Butted	0,042
	59 x 125	20 - 80	Butted	0,042
	60 x 83	100 - 160	Butted	0,042

Wooden subsurface:



Minerally subsurface:

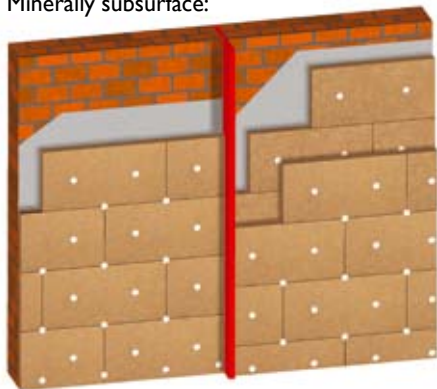

Wood frame constructions:

Type of board	Length x Width (cm)	Thickness (mm)	Type of edge	λ W/mK
GUTEX Thermowall-gf	60 x 130	40 / 60	T&G	0,046
	125 x 260/280	40 / 60	Butted	0,046
GUTEX Thermowall	60 x 130	80/100/120	T&G	0,042
	125 x 260/280	80/100/120	Butted	0,042

Wood frame construction:

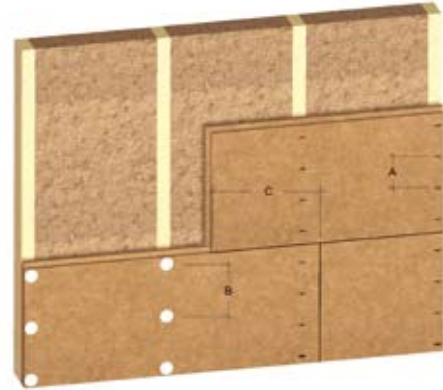

Installation Instructions:

- Vacuum to remove all dust and dirt.
- For more detailed information about installation, including fastening and application of plaster, refer to the GUTEX brochure, "Composite Thermal Insulation Systems."

All rights reserved. GUTEX Holzfaserplattenwerk H. Henselmann GmbH + Co KG is not liable for any errors or misprints. The technical data provided herein may be subject to change. Although all of the information was up to date at the time these data sheets were

printed, with the publication of superseding information, the old information loses its validity. In certain isolated cases, specific products may not be suitable for a given application. Warranty and liability apply as defined in our General Terms of Business.



NATURALLY MADE OF WOOD