





GUTEX® Thermosafe-wd Data Sheet



Photographic images are property of GUTEX archive

Technical Data	Thermosafe-wd	
	Butted	Rebate
Joint type	Butted	Rebate
Thickness (mm)	20/30/40/60/ 80/100/ 120	140/160
Length x width (mm)	1250 x 600	1250 x 600
Actual coverage (mm)	1250 x 600	1235 x 585
Square metres per board (m ²)	0.75	0.75
Weight per board (kg)	2.1/3.2/4.2/ 6.3/8.4/10.5 /12.6	14.7/16.8
Weight per m ² (kg)	2.8/4.2/5.6/ 8.4/11.2/14/ 16.8	19.6/22.4
Boards per pallet	220/140/ 108/72/ 54/44/36	32/28
Square metres per pallet (m ²)	165/105/81/ 54/ 40.5/ 33/27	24/21
Weight per pallet (kg)	490	490
Bulk density (kg/m ³)	140	140
Nominal thermal conductivity λ_D (W/mK)	0.039	0.039
Nominal thermal resistance R_D (m ² K/W)	0.51/0.77/ 1.03/1.54/ 2.05/2.56/3.0	3.59/4.10
Vapour diffusion factor (μ)	3	3
sd-value (m)	0.06/0.09/ 0.12/0.18/ 0.24/0.30/0.36	0.42/0.48
Compressive stress/strength (kPa)	70	70
Tensile strength perpendicular to board surface (kPa)	10	10
Air flow resistivity (kPa s/m ³)	100	100
Specific heat capacity (J/kgK)	2100	2100
Fire reaction Euro Class as per DIN EN 13501-1	E	E

GUTEX Thermosafe-wd, an insulating board with singly construction and homogenous cross section, features exceptionally high compression resistance. It is ideal for any wall or floor structure.

Composition

- Manufactured from untreated Black Forest spruce and fir
- Additive: 4 % polyurethane resin

Applications

- Insulation under screed and floor coverings
- Above and between rafter insulation
- Interior insulation of ceilings, walls, floors or roofs
- Insulation of timber frame and prefab modular house sections
- Insulation of top storey ceilings

Advantages

- Excellent thermal insulation properties: $\lambda=0.042$ W/mK
- Outstanding thermal storage capacity provides excellent insulation against heat in the summer and cold in winter
- Significantly improves soundproofing
- Regulates humidity and is vapour diffusion permeable
- Compression resistant
- Manufactured from wood, a sustainable, recyclable natural resource
- Made in Germany
- Biologically safe (natureplus® certified)

Designation: WF-EN 13171-T4-CS(10/Y)70-TR10-MU3-AF100.

* Approval number: 23.15-1404.

German disposal category: A2 (treated wood; without non-halogenated organic compounds); code number as per AVV:030105; 170201

Installation

- Store and install this product dry.
- Offset the joints if installing multiple layers.
- Avoid cross joints.
- For best cutting results, use a GUTEX saw or GUTEX blades for jigsaws or handheld circular saws and a vacuum fitting.
- Vacuum off the dust in accordance with applicable workplace safety regulations or practices.
- Substrate must be dry, even and technically sound.
- Protect this product against moisture.
- Edge stripping must be as high as the total built-up height of the floor.

Maximum Built-up Height

Floor Covering over GUTEX Thermosafe-wd	Maximum Built-up Height GUTEX Thermosafe-wd
Wet screed	140 mm
Mastic asphalt	140 mm
Sub-floor fibreboard \geq 25 mm	140 mm
OSB sub-floor board \geq 22 mm	140 mm
GUTEX Thermosafe-nf	100 mm
Gypsum screed elements \geq 25 mm	100 mm
Prefinished engineered wood flooring \geq 14 mm	30 mm
Laminate flooring \geq 8 mm	20 mm

Layout Pattern

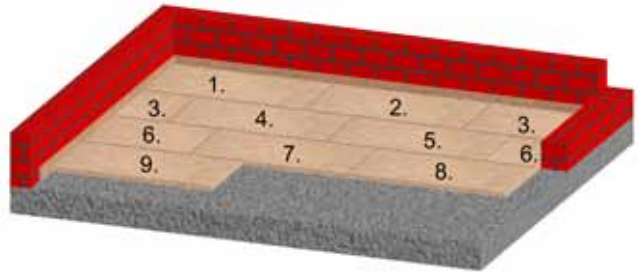

GUTEX Thermosafe-wd installs in offset joint arrangement. Use the oddment of the last board of a row to start the next row (refer to layout plan).

Floor Construction

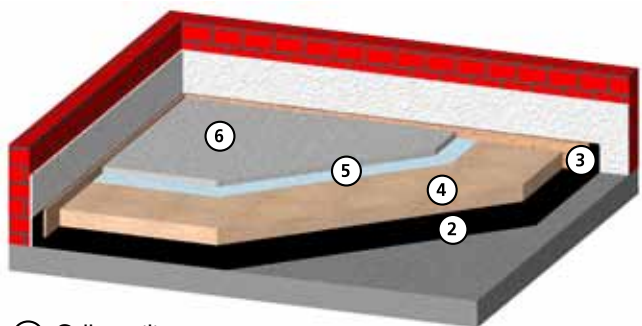

- ① Cellar ceiling
- ② Moisture barrier is required
- ③ Edge strips
- ④ GUTEX Thermosafe-wd
- ⑤ Moisture barrier
- ⑥ Wet screed

All rights reserved. Henselmann GmbH + Co KG is not liable for any damage resulting from error or misprinting. The technical data provided herein is subject to change. Although all of the information was current at the time of its publication, the publication of superseding

information renders the old information invalid.

The suitability of this product for applications not specified in this data sheet is not guaranteed. Warranty and liability claims are subject to the terms of GUTEX's General Terms of Business.



NATURALLY MADE FROM WOOD