





# **GUTEX**® Happy Step Data Sheet



Photographic images are property of GUTEX archive

**GUTEX Happy Step** is the ideal underlay for high-quality, interior floor coverings.

Technical Data	Happy Step
Joint type	Butted
Thickness (mm)	4/6
Length x width (mm)	860 x 590
Square metres per sheet (m <sup>2</sup> )	0.51
Weight per m <sup>2</sup> (kg)	0.96/1.56
Weight per sheet (kg)	0.5/0.8
Sheets per package	18/20
Packages per pallet	50/32
Sheets per pallet	900/640
Square metres per pallet (m <sup>2</sup> )	456.66/324.74
Weight per pallet (kg)	560
Bulk density (kg/m <sup>3</sup> )	240/260
Nominal thermal conductivity $\lambda_D$ (W/mK)	0.046
Nominal thermal resistance $R_D$ (m <sup>2</sup> K/W)	0.087/0.13
Vapour diffusion factor ( $\mu$ )	5
sd-value (m)	0.02/0.03
Compressive stress/ strength (kPa)	100
Air flow resistivity (kPa s/m <sup>3</sup> )	100
Specific heat capacity (J/kgK)	2100
Fire reaction Euro Class as per DIN EN 13501-1	E

Designation: WF-EN 13171-T4-WS2,0-CS(10/Y)70-TR7,5-MU3-AF100

\*Approval No. 23.15-1404.

German disposal category: A2 (treated wood; without non-halogenated organic compounds)

Code number as per AVV: 030105; 170201

## Composition

- Manufactured from untreated Black Forest spruce and fir
- Additives:  
1.5% paraffin (hydrophobic agent)  
Max. 0.1% colouring

## Applications

- Underlay for cork flooring (min. 6 mm), prefinished engineered wood flooring, laminate flooring and fitted carpet
- Over concrete, screed, poured asphalt, wood, sub-floor boards and dry screed elements

## Advantages

- Suitable for retrofitting to increase existing impact sound insulation
- Depending on the floor construction, it can improve the impact sound insulation by up to 30 dB.
- Ideal for upgrading the thermal insulation of existing structures
- Regulates humidity
- Water vapour diffusion permeable
- Impact softening makes floors more pleasant to walk on.
- Fast installation
- Fewer tools required for installation
- Wood is a sustainable, recyclable natural resource.
- Made in Germany
- Biologically harmless!

## Installation

- To ensure proper performance, uncompromising compliance to the flooring manufacturer's guidelines is necessary!
  - Store and install this product dry.
  - Protect this product against moisture.
  - Substrate must be dry, even and technically sound.
  - Use GUTEX flooring knife or a carpet knife to cut.
  - Avoid cross joints.
  - Maintain 1 cm distance to wall.
- If an adhesive must be used (e.g. carpeting) use a carpet adhesive to glue GUTEX Happy Step.
  - Vacuum off the dust in accordance with applicable workplace safety regulations or practices.

## Layout Pattern

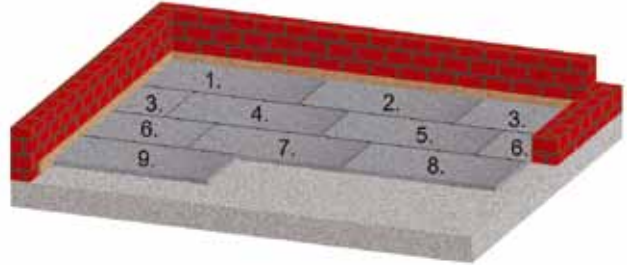

## Floor Construction

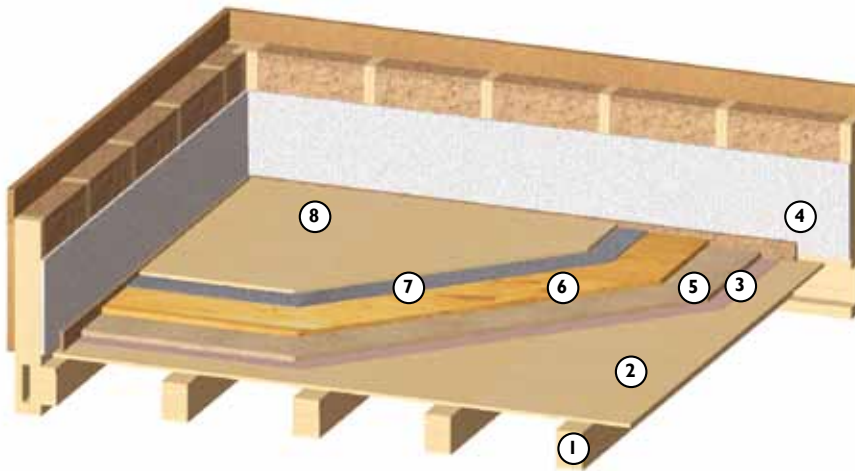

- |                  |                              |                       |   |
|------------------|------------------------------|-----------------------|---|
| ① Exposed joists | ③ Trickle protection barrier | ⑤ GUTEX Thermosafe-wd | ⑦ GUTEX Happy Step  |
| ② Exposed liner  | ④ Edge strips                | ⑥ OSB board           | ⑧ Prefinished engineered wood flooring/ laminate flooring |

## Floor Constructions for Different Floor Coverings

### Cork:

- Glue full surface of GUTEX Happy Step with carpet adhesive to the sub-floor.
- Glue cork (minimum of 6 mm) with carpet adhesive to GUTEX Happy Step.

### Carpet:

- Glue GUTEX Happy Step to the sub-floor with full adhesive coverage.
- Glue the carpet.

- If delicate or low-pile carpets are used, the seams may show through.
- Not suitable for wheelchairs. Avoid applying excessive pressure to specific points, as this may create permanent recesses.

### Prefinished Engineered Wood Flooring/ Laminate Floors

- Install GUTEX Happy Step, so that it floats.
- Install engineered flooring or laminate, so that it floats (compliant to manufacturer's instructions).
- If the substrate is subject to moisture ingress, provide suitable moisture protection.

All rights reserved. Henselmann GmbH + Co KG is not liable for any damage resulting from error or misprinting. The technical data provided herein is subject to change. Although all of the information was current at the time of its publication, the publication of superseding

information renders the old information invalid.

The suitability of this product for applications not specified in this data sheet is not guaranteed. Warranty and liability claims are subject to the terms of Gutex's General Terms of Business.



NATURALLY MADE FROM WOOD